

Date	Rev. date	Work nr.  M35/S01	Drw. nr.	Rev.
Drawn by Ruukki	Rev.		-	
Scale 1:2	Building	File nr. P2021/001-00036		

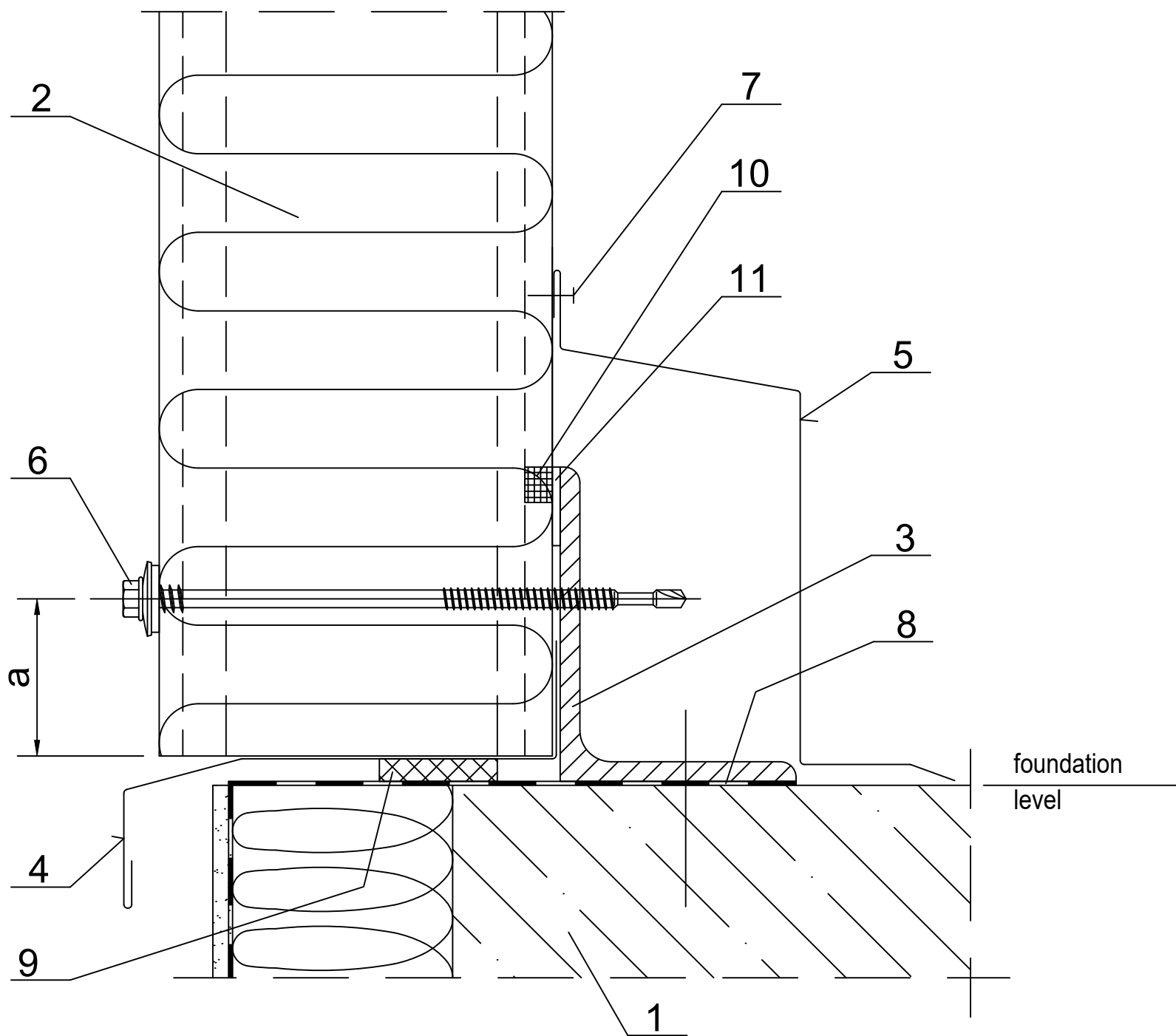

- 1. Ground beam acc. to engineering design of the structure
- 2. Ruukki nSPD WE.
- 3. Socle sheeting rail acc. to engineering design of the structure
- 4. EA1B01 plinth flashing.
- 5. EA1B02 plinth flashing.
- 6. Panel fastener for hot-rolled sheeting rail or for cold-bent sheeting rail.
- 7. Steel rivet (every 300 mm).
- 8. Horizontal insulation acc. to architectual design of the structure
- 9 Impregnated polyurethane sealant.
- 10. Permanently elastic sealing compound in panel joint .
- 11. 4x20 PE self-adhesive sealant.

panel thickness [mm]	min. distance from the panel edge "a" [mm]
< 150	30
≥ 150	40